

LIMITLESS™
AirPro™
 Quick Start Guide



TECH SPECS

Model: LIM-AP4B1-XXX
Battery Capacity: 4,000mAh | 3.7V
Recharging Time (From 0%): ±3 Hours
Battery Level Display: 5% - 100%

Type-C Port (Input): 5V/2A
USB Charging Port (Output): 5V/2.4A

Max Operating Pressure: 120 PSI / 8.3 bar
Max Instant Pressure: 150 PSI / 10.3 bar
Air Pressure Range: 3-150 PSI / .2-10.3 bar
Range Resolution: 1 PSI / 0.1 bar
Air Pressure Tolerance: ±1.5%

Product Working Temperature:
 32°-104°F (0°-40°C)
Charge Operating Temperature:
 32°-113°F (0°-45°C)
Discharging Operating Temperature:
 14°-140°F (-10°-60°C)

Flashlight: 25 Lumens
Flashlight Modes: On | S.O.S. | Strobe
Dimensions: 6.43" x 2.76" x 2.13"
Weight: 15.2 oz (0.95 lb)

WHAT'S INCLUDED

- A. (1) AirPro™
- B. (1) Storage Bag
- C. (1) 12" Type-C to USB Charging Cable
- D. (1) 1-Port USB Car Charger
- E. (1) 24in 3-In-1 USB Charging Cable
- F. (1) 8" Hose
- G. (1) 24" Hose with Air Chuck
- H. (1) Inflatable Adapter
- I. (1) Ball Adapter
- J. (1) Bike Tire Adapter

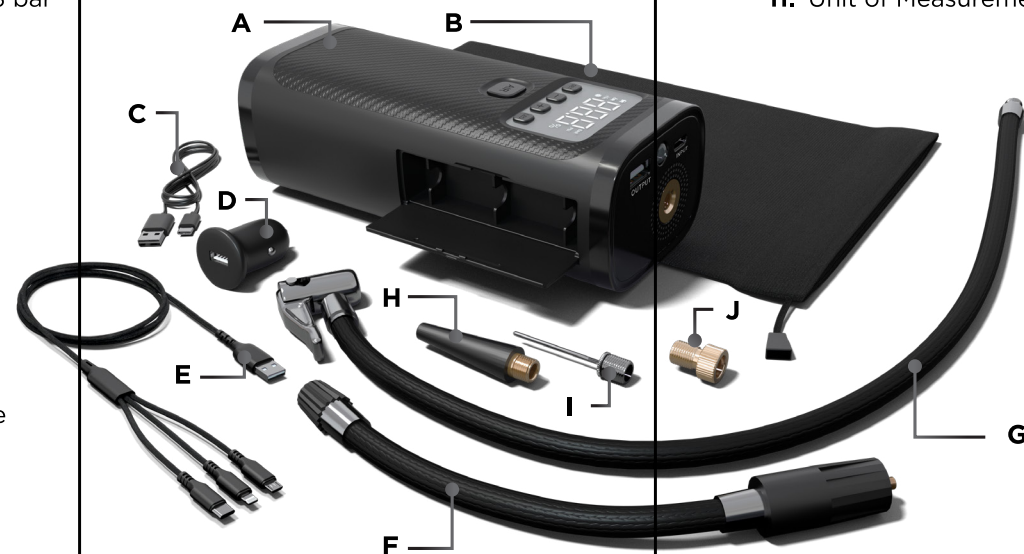

COMPONENTS

- 1. USB Charging Port (Output)
- 2. Flashlight
- 3. Threaded Air Hose Connection
- 4. Type-C Port (Input)
- 5. Exhaust
- 6. Adapter Storage Door
- 7. Adapter Storage Slot
- 8. Control Panel
- 9. Air Compressor Mode
- 10. Digital Display
- 11. Unit of Measurement

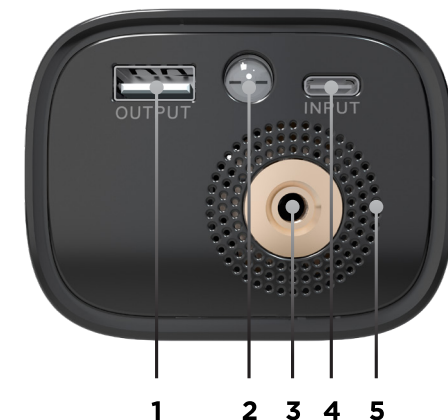

ADAPTER COMPATIBILITY

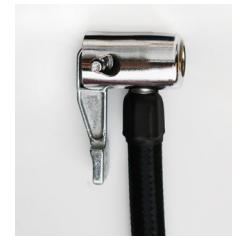

Air Chuck
 Cars, Trucks, Trailers,
 ATVs, Motorcycle
 Tires & more.

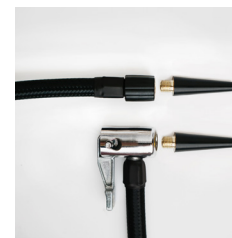

Inflatable Air Nozzle
 Pool Tubes, Floats,
 Balloons, Toys, etc.



Ball Pump Needle
 Basketballs, Soccer
 Balls, Footballs,
 Volleyballs, etc.

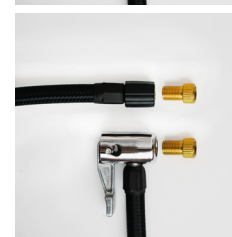

Presta Valve
 Bicycle Tires

LIMITLESS™

All rights reserved. Limitless AirPro™, AirPro™, and Limitless™ are trademarks of Limitless Innovations, Inc. Design and specifications subject to change without notice. Products may vary from images shown. Accessories sold separately.

LimitlessInnovations.com
 Support@LimitlessInnovations.com
 (855) 843-4828

Limitless Innovations, Inc.
 4800 Metalmaster Way
 McHenry, IL 60050

© Limitless Innovations, Inc.



SCAN TO LEARN MORE



@LimitlessInnovations



/LimitlessInnov



/LimitlessInnov



/LimitlessInnov



Limitless Innovations

Designed in USA. Made In China.

CONTROL PANEL

AIR

Press:
Power AirPro™ On
Press & Hold (2 Seconds):
Activate Air Compressor

SET

Press:
Switch Pump Modes
Press & Hold (2 Seconds):
Switch PSI / BAR

-

Press:
Decrease 1 PSI / 0.1 bar
Press & Hold:
Continual Decrease
Until Released

+

Press:
Increase 1 PSI / .1 bar
Press & Hold:
Continual Increase
Until Released

LED

Press:
Switch Light Modes
Press & Hold (2 Seconds):
Turn Off Without Cycling
Through the Light Modes

HOW TO USE

Powering On The AirPro™

- Press the AIR button to turn the AirPro™ on.
- The battery level will illuminate on the Digital Display for 5 seconds (below).
 - The Digital Display will switch to the PSI/BAR indicator. The Car icon and current PSI will illuminate on the Digital Display. The Digital Display will read "0" if nothing is attached to the AirPro™. The default unit of measurement is set to PSI (right).

Note:
The AirPro™ will automatically shut off after being idle for 60 seconds.

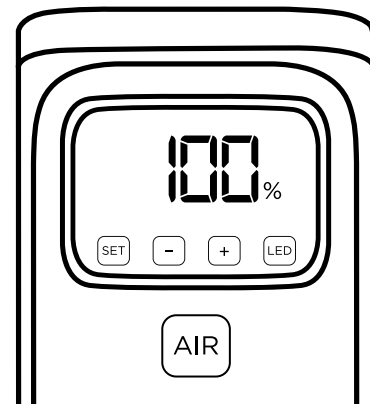

Adjusting the Modes

Use the SET, +, and - buttons to adjust the PSI/BAR setting to the desired level. Refer to the Control Panel instructions (left) and the default settings (below).

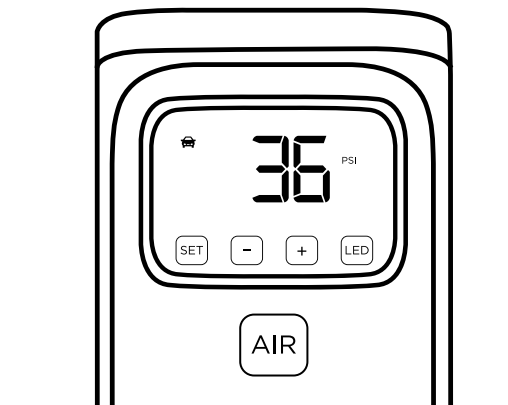

| DEFAULT SETTINGS | | | |
|------------------|------------|-----|-----|
| | MODE | PSI | BAR |
| | Car | 36 | 2.5 |
| | Motorcycle | 36 | 2.5 |
| | Bike | 60 | 4.1 |
| | Ball | 8 | .5 |

Connecting The Air Hoses

- Screw the end of the 8" Hose into the AirPro™'s Threaded Connection.
- To use the 24" Hose with Air Chuck, you must first attach the 8" Hose to the AirPro™.

Note:
The 24" Hose with Air Chuck can be used as an extender to create a 32" hose that works with the Adapters.

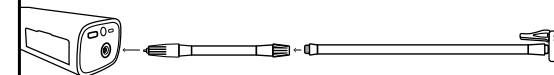

Connecting The Adapters

To the 8" Hose:

- Screw the threaded end of the Adapter into the end of the 8" Hose. Do **NOT** over tighten the Adapter.

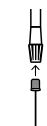

To the 24" Hose with Air Chuck:

- Open the Lever of the Air Chuck and insert the threaded end of the Adapter.
- Close the Lever to secure the Adapter in the Air Chuck.

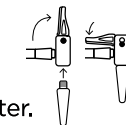

Using The Air Pump

- Power on the AirPro™, adjust the modes, and connect the Air Hoses.
- Once the Digital Display switches to the PSI/BAR Indicator, press and hold the AIR button to activate the air compressor.
- The air compressor will automatically shut off once the preset PSI/BAR level has been met.
* Press the AIR button to manually turn off the air compressor at any time.

Notes:
When using the air compressor for extended periods of time, It is recommended to allow the unit to cool after 8 minutes has surpassed to prevent over-heating.

Always refer to the manufacturer's recommended PSI/BAR level for the item being inflated.

Air Compressor Built-In Protection Codes

- E01 | Protection Type:**
Battery Over-Temperature Protection
Troubleshooting: Turn off the AirPro™ and allow 10 minutes to cool down.
- E02 | Protection Type:**
Motor Over-Temperature Protection
Troubleshooting: Turn off the AirPro™ and allow 10 minutes to cool down.

- E03 | Protection Type:**
Leakage Protection
Troubleshooting: Disconnect and reconnect the Air Hose.

Checking the Tire Pressure

- Connect the 8" Hose to the AirPro™.
- Connect the 24" Hose with Air Chuck to the end of the 8" Hose.
- With the Lever open, connect the Air Chuck to the vehicle's air valve.
- Quickly close the Lever to secure it on the vehicle's air valve and avoid releasing air from the tire. The Digital Display will illuminate the current PSI.

Using The Flashlight

- Press the LED button once to turn on the Flashlight.
 - Single press the LED button to cycle through the light modes.
 - Press and hold the LED button for 2 seconds to turn off the Flashlight without cycling through the light modes.

Light Modes: On | S.O.S. | Strobe

Recharging The AirPro™

- Plug the included 1-Port USB Car Charger into a vehicle's 12V outlet.
- Plug the included 12" Type-C to USB Charging Cable into the 1-Port USB Car Charger and into the Type-C Port on the AirPro™.
- The AirPro™ will begin to charge.
* The 12" Type-C to USB Charging Cable can be used with any USB power source to recharge the AirPro™ indoors.

Using The Power Bank

- Plug the 24" 3-In-1 USB Charging Cable into the USB Charging Port.
*Any compatible USB charging cable can be used with the AirPro™.
- Determine which connector is compatible with the device and plug it into the charging port.
Compatibility:
Micro: Select Tracfoes, Speakers, Cameras, Power Banks, & More
Lightning: Compatible with iPhones, AirPods, & Most Apple Devices
Type-C: Compatible with newer devices by Samsung, Microsoft, Google, LG, Huawei, select Apple iPads (2018 and newer), select Tracfoes, and More
- Press the AIR or LED button to power on the AirPro™. The device will begin to charge.